

# 21135 ERWIN STREET

# UP TO 78,000 SF FOR LEASE

Woodland Hills, CA 91367



 **NETWORK  
TELEPHONE  
SERVICES, INC.**  
[www.21135erwin.com](http://www.21135erwin.com)

**DAN COLEMAN**  
T. 818.227.1145  
[dhc@nts.net](mailto:dhc@nts.net)

**JOE PRESTON**  
T. 818.992.4300  
[jdp@nts.net](mailto:jdp@nts.net)

**NTS/WARNER RANCH PROPERTIES**  
21135 Erwin Street  
Woodland Hills, CA 91367  
[www.21135erwin.com](http://www.21135erwin.com)

# 21135 ERWIN STREET

# UP TO 78,000 SF FOR LEASE

Woodland Hills, CA 91367

FEATURES

SITE PLAN

LOCATION

AERIAL

PRINT ALL

EXIT

## PROPERTY FEATURES

- Up to 78,000 SF Office Available For Lease
- Divisible To 15,000 SF
- Prime Warner Center Location
- Sharp, Clean, Corporate Facility
- Flexible Layout For Office/R&D Use
- Ample free surface parking



AVAILABLE SF

LEASE RATE

AVAILABILITY

PARKING

Up to 78,000 SF

Negotiable

Immediate

Ample free surface parking

# 21135 ERWIN STREET

# UP TO 78,000 SF FOR LEASE

Woodland Hills, CA 91367

FEATURES

FIRST FLOOR PLAN

LOCATION

AERIAL

PRINT ALL

EXIT

SECOND FLOOR PLAN

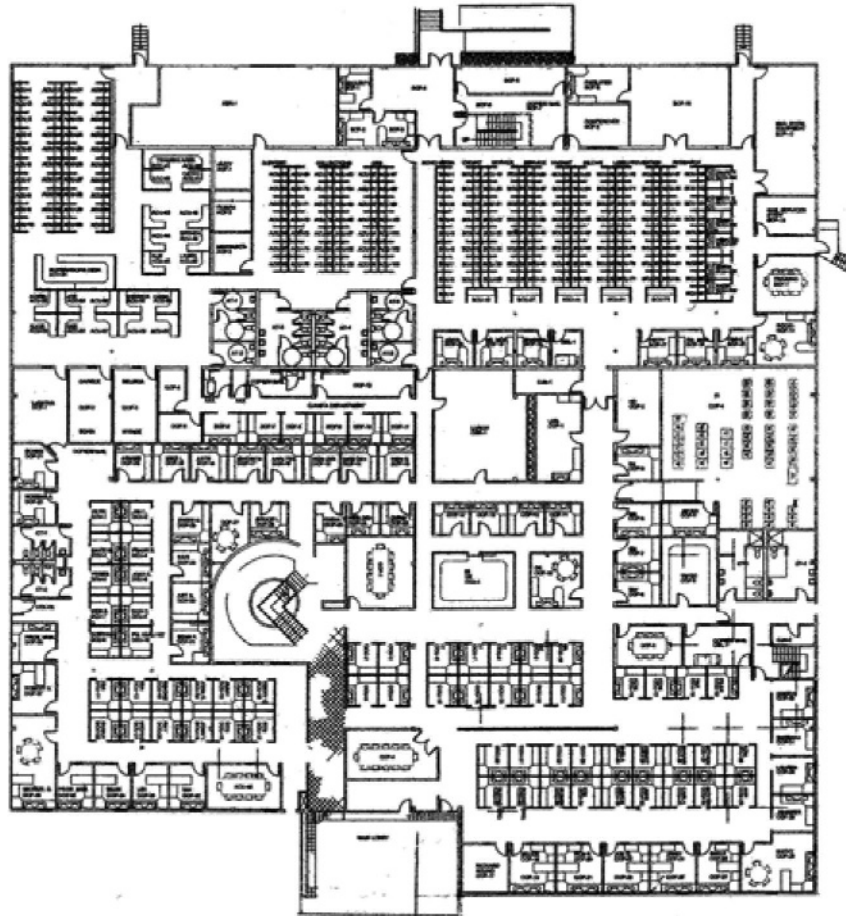

# 21135 ERWIN STREET

# UP TO 78,000 SF FOR LEASE

Woodland Hills, CA 91367

FEATURES

FIRST FLOOR PLAN

LOCATION

AERIAL

PRINT ALL

EXIT

SECOND FLOOR PLAN

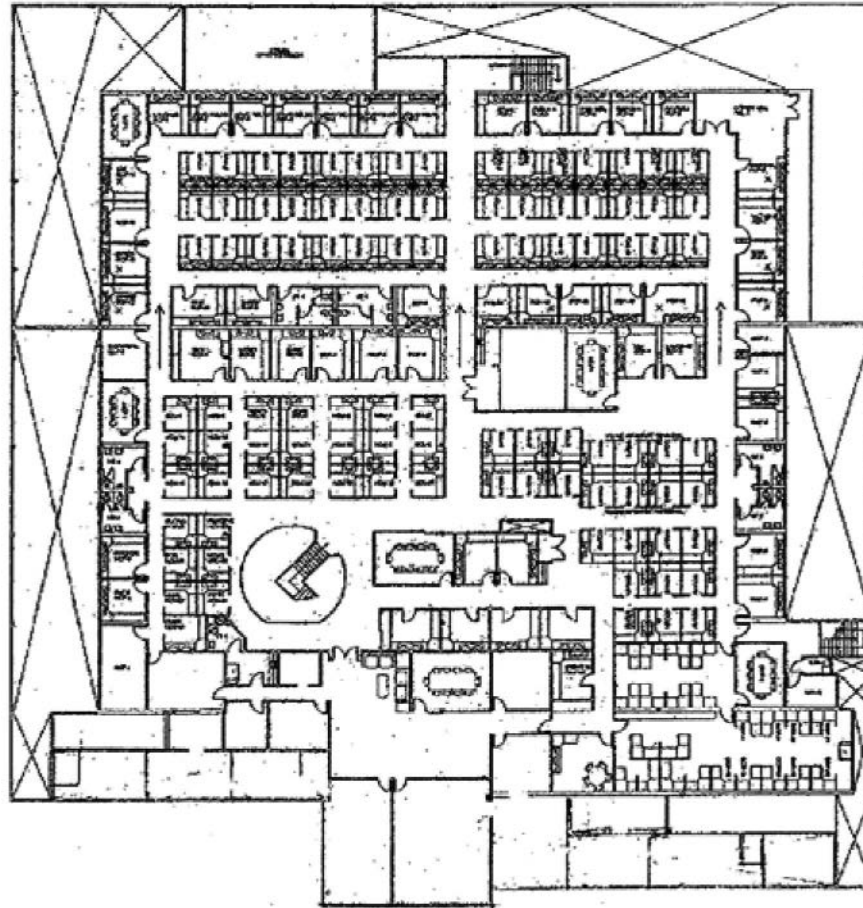

# 21135 ERWIN STREET

# UP TO 78,000 SF FOR LEASE

Woodland Hills, CA 91367

FEATURES

SITE PLAN

LOCATION

AERIAL

PRINT ALL

EXIT



# 21135 ERWIN STREET

# UP TO 78,000 SF FOR LEASE

Woodland Hills, CA 91367

FEATURES

SITE PLAN

LOCATION

AERIAL

PRINT ALL

EXIT

